

**PROJECT**  
 PROPOSED 6 NOS. OF B+G+P+28 STORED RESIDENTIAL COMPLEX AND 153 NOS. OF G+2 ROW HOUSING FOR DTC PROJECTS PVT. LTD. AT DAG NO. 833 AND 884 AT MOUZA - KAMDUNI (188), UNDER KIRTIPUR-II GRAM PANCHAYAT, P.O - KAMDUNI, DISTRICT NORTH 24 PARGANAS, PIN - 700135, WEST BENGAL.

- NOTES:**
- ALL DIMENSIONS ARE IN MM UNLESS IT IS MENTIONED.
  - THE RAIN WATER AND SITE WATER DISPOSAL IS COLLECTED FOR RAIN WATER HARVESTING.
  - ALL ELECTRICAL INSTALLATIONS SHALL BE AS PER PROVISION OF NBC.
  - FIRE-FIGHTING / SAFETY PROVISIONS WILL BE AS PER RELEVANT NBC PROVISIONS.
  - ALL TOILETS ARE VENTILATED AS PER WEST BENGAL MUNICIPAL BUILDING RULES, 2007
  - BUILDING WILL BE DESIGNED (STRUCTURES) AS PER RELEVANT I.S. CODES FOR EARTHQUAKE RESISTANCE.
  - PLEASE NOTE THAT THE DIMENSIONS IN THE DRAWINGS ARE TO BE READ, NOT MEASURED.

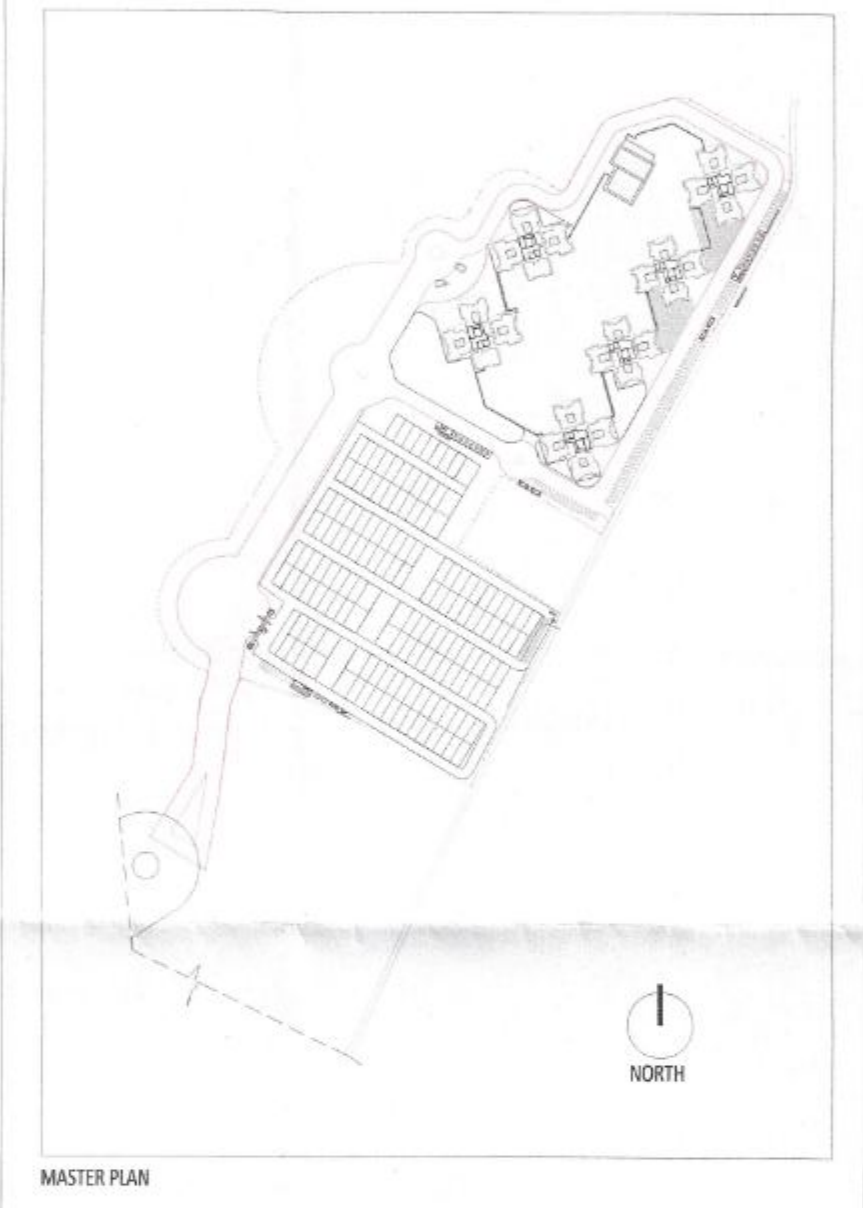

MASTER PLAN

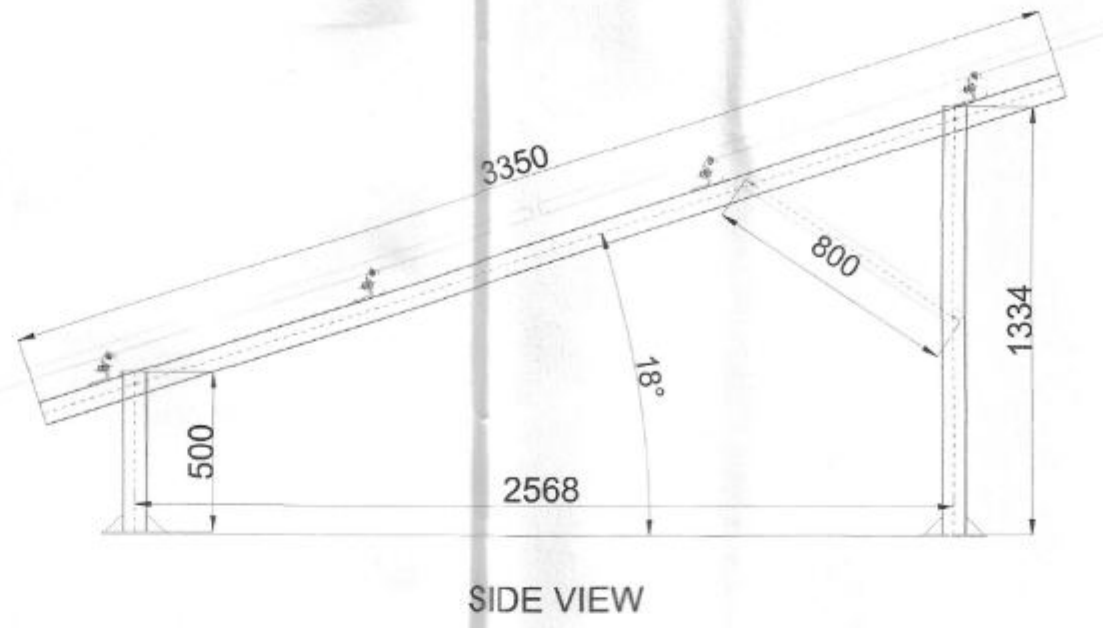

SIDE VIEW

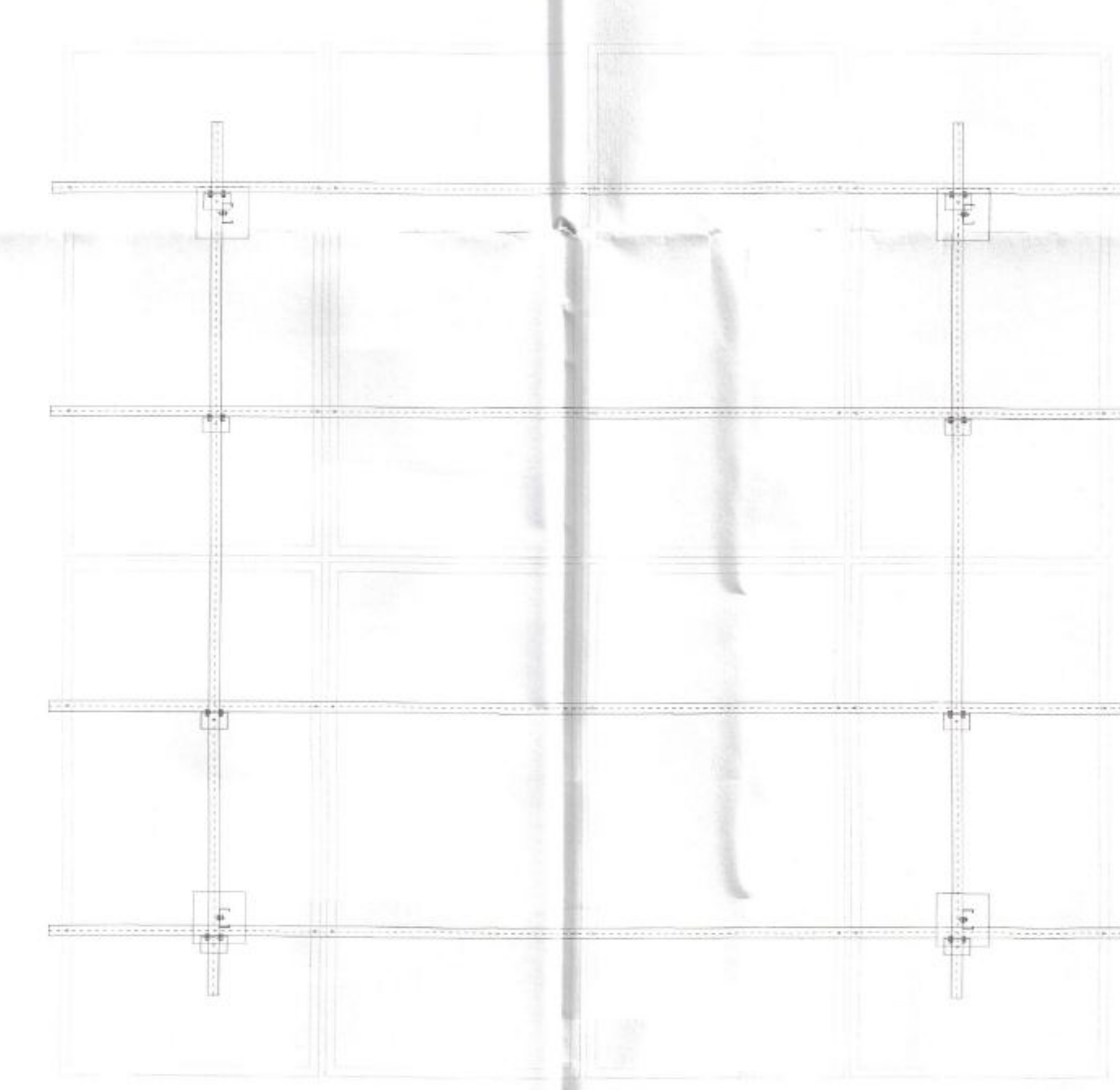

TYPICAL SOLAR PANEL LAYOUT  
 TYPICAL DETAIL

WE DO HEREBY CERTIFY THAT THE FOUNDATION AND SUPERSTRUCTURE OF THE BUILDING PROPOSED FOR CONSTRUCTION ON THIS PREMISES HAVE BEEN SO DESIGNED BY ME/US WILL MAKE SUCH FOUNDATION AND SUPERSTRUCTURE SAFE IN ALL RESPECT INCLUDING THE CONSIDERATION OF BEARING CAPACITY AND SETTLEMENT OF SOIL ETC.

*[Signature]*  
 GEO TECHNICAL ENGINEER

THE STRUCTURAL DESIGN AND DRAWINGS OF BOTH FOUNDATION & SUPERSTRUCTURE OF THE BUILDING HAS BEEN MADE BY ME CONSIDERING ALL POSSIBLE LOADS INCLUDING THE SEISMIC LOAD AS PER THE NATIONAL BUILDING CODE OF INDIA AND CERTIFIED THAT IT IS SAFE AND STABLE IN ALL RESPECTS.

*[Signature]*  
 ANKIT AGARWALA  
 B.E. (CIVIL), M.E. (STRUC)  
 CIVIL & STRUCTURAL CONSULTANT  
 REGISTRATION NO. 07352090  
 CLASS-1, E.S.E. 1/172

SIGNATURE OF STRUCTURAL ENGINEER & SEAL  
 CIVIL AND STRUCTURAL CONSULTANT  
 M.N. Consultants (Pvt). Ltd.  
 ISO 9001:2008 CERTIFIED  
 "M.N.C. HOUSE"  
 1516, Rajdanga Main Road,  
 Kolkata-700 107.  
 Ph.no.-(033)4016-5700  
 FAX NO. 2441-8083  
 E-MAIL: mncmpl2008@gmail.com

CERTIFIED THAT I HAVE GONE THROUGH THE WEST BENGAL MUNICIPAL BUILDING RULES 2009 AS AMENDED TIME TO TIME AND ALSO UNDER TAKE TO ABIDE BY THOSE RULES DURING AND AFTER CONSTRUCTION OF BUILDING

DTC PROJECTS PVT. LTD.  
*[Signature]*  
 SIGNATURE OF OWNER & SEAL  
 DTC PROJECTS PVT. LTD.  
 ADDRESS : 1 NS ROAD, KOLKATA-700001

I CERTIFY THAT THE BUILDING HAS BEEN DRAWN UP AS PER PROVISION OF WEST BENGAL MUNICIPAL BUILDING RULES 2009 AS AMENDED TIME TO TIME AND AS PER THE SITE CONDITION WHERE IN, THE PLOT IS BOUNDED BY BOUNDARY WALLS AND PILLARS AND IT CONFIRMS WITH THE PLAN IT IS A BUILDABLE SITE AND NOT A TANK OR FILLED UP TANK.

*[Signature]*  
 KETAN HINGANIKAR  
 CA/2008/37536  
 SIGNATURE OF ARCHITECT & SEAL

ARCHITECT  
 morphogenesis  
 Plot No. 41, Industrial Estate, Okhla  
 Phase-II, New Delhi 110020, India  
 TEL: +91 11 4828070  
 FAX: +91 11 26490351  
 Email: studio@morphogenesis.org

SCALE: 1:500  
 DATE: 05.06.2025  
 TITLE: SOLAR ARRAY PLAN  
 NORTH

TOWERS	CAPACITY OF SOLAR PANEL IN KWp	STATUS
TOWER-1	15	PROPOSED
TOWER-2	15	PROPOSED
TOWER-5	15	PROPOSED
TOWER-6	20	PROPOSED
TOTAL	65	

The structural analysis reports & soil reports are kept for reference in this office. The clearance is accorded subject to certificate of architect. Sr. Engineer, Geo-Tech Engineer.  
*[Signature]*  
 13/11/25

**NOTE:**  
 TOTAL POWER LOAD IN PHASE-2 (GH & RH) IS 6510 KW. REQUIRED/CONSIDERED 1 % SOLAR LOAD IN PHASE-2 IS 60 KW.  
 PROVISION OF SOLAR PANEL IS IN TOWER-1,2,5,6. EACH TOWER SOLAR PANEL CAPACITY IS 15 KW.

1 SOLAR ARRAY PLAN  
 1/200